

## Downtown Streets & Parking Lots

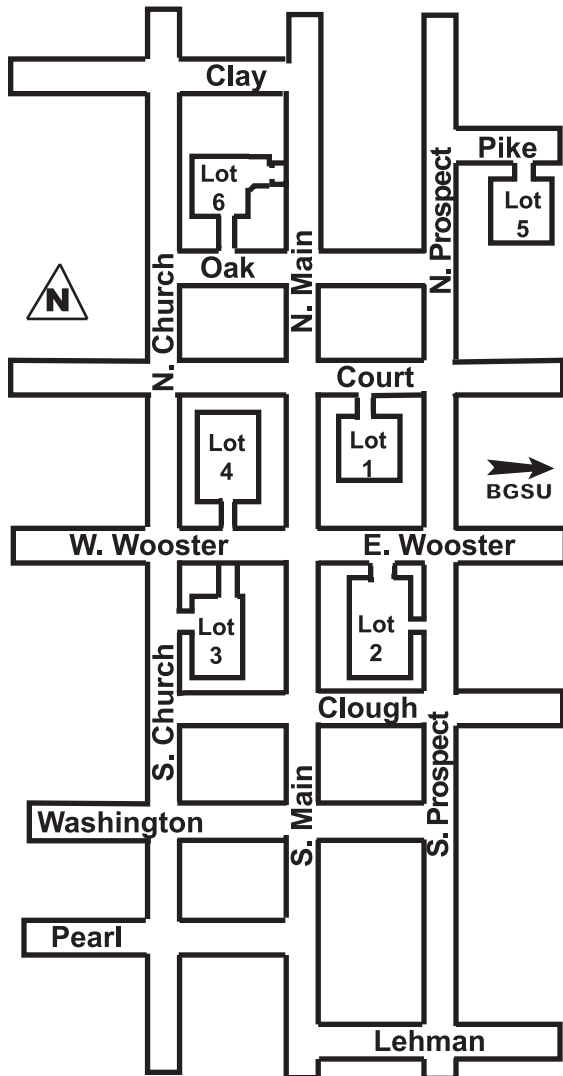

## Parking Fees & Time Limits

On-street and lot parking are available throughout the downtown.

The time limit for on-street parking in the downtown district is 2 hours unless otherwise posted. Most on-street parking is free.

Meters are enforced M-F, 9 a.m.-5 p.m. They accept nickels, dimes and quarters, with an hour costing 25 cents.

There are two types of meters, 2-hour meters and 10-hour meters.

2-hour meters are generally closer to the businesses, while the 10-hour meters are generally in the backs of the parking lots.

The 2-hour meters have yellow heads and the 10-hour meters have black heads.

Parking is free on Saturdays, Sundays, and observed holidays.

## Finding Address Numbers

The intersection of Wooster and Main Streets marks the boundaries of East/West and North/South street designations. The odd and even street numbers change sides of the street at this intersection as well.